



Performance Products
The competitive edge!

***Bearing Spacers,
Tools &
Components***

Summer 2011



"Let us run with endurance the race that is set before us..." Hebrews 12:1
2089 Crooked Oak Road Rocky Mount, Virginia 24151 888-399-6074 540-484-1756 Fax
www.DRPperformance.com

Tools • Brakes • Driveline • Suspension • Cooling



Bearing Spacers

Our patented Hub Bearing Spacers allow for consistent and precise bearing load every time the spindle nut is tightened, regardless of the torque applied. Without a bearing spacer, bearings are typically over tightened to prevent loosening during the race. With a bearing spacer installed, you can completely tighten the spindle nut and the hub will spin free every time. Bearing spacers save time, reduce bearing temperature and greatly increase wheel free spin, putting more horsepower to the wheels. You can feel the difference by simply pushing the car!

Testing has shown that the bearing spacer will make more difference than any "Low Drag" bearing set up currently available. When the spacer is used in conjunction with "Low Drag" Tapered bearings and seals, you will have the ultimate Low Drag set-up. Also works with angular contact style bearings. Instructions included. Made in the USA of premium quality materials. Satisfaction guaranteed.

- **US Patent No. 6,312,162**
- **200%-300% More Free Spin vs. No Spacer!**
- **Makes Servicing Hubs Simple & Quick.**
- **Bearings Run Cooler**
- **Saves Time**
- **Eliminates Bearing "Spin" on Spindle**
- **Distributes Side Load Evenly Across Bearings**
- **Works on Tapered and Angular Contact Bearings**
- **Once Set, typically never has to be adjusted unless bearings or hub is replaced.**
- **Instructions Included**
- **Precision Machined in the USA**
- **+/- .001" Minimum Parallelism**
- **Custom Applications Available**
- **Satisfaction Guaranteed!**

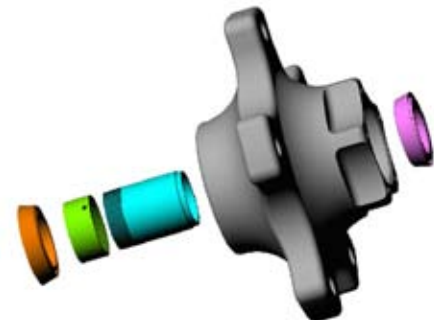

"Let us run with endurance the race that is set before us..." Hebrews 12:1



Wide Five



2 7/8" Bearing Wide Five



2" Bearing 5x5



Short Track 5x5 Front



Short Track 5x5 Rear



CUP Style Front



CUP Style Rear



GM #2 Spindle



Canadian Tire Series Front



Impala Front



Sprint Car Front



Mustang Front



Camaro Front

Item Number	Description	Fits Bearing Numbers	Price
007 10500	Bearing Spacer; Wide Five; Steel; Adjustable	18690/18790	\$46.95
007 10501	Bearing Spacer; Wide Five; Aluminum; (Machine to Fit)	18690/18790	\$29.95
007 10505	Bearing Spacer; 2" 5x5 (368A Bearings); Steel; Adjustable	368A	\$46.95
007 10510	Bearing Spacer; 2 7/8" Big Bearing Wide Five (Bert/Winters; Rear; Adjustable	8658 or OD-BCD-021	\$54.90
007 10512	Bearing Spacer; 2 7/8" Big Bearing Wide Five (Bert/Winters); Front; Adjustable	8658 or OD-BCD-021	\$54.90
007 10515	Bearing Spacer; Short Track 5x5 Front; (SCP Style); Adjustable	3383/2687	\$59.90
007 10518	Bearing Spacer; 2.5" Short Track 5x5 Rear; Adjustable	L610549	\$59.90
007 10519	Bearing Spacer; Speedway Engineering MOD LITE Rear Hub; Steel; Adjustable	18690	\$46.95
007 10520	Bearing Spacer; Impala Front; Aluminum/Steel; Adjustable	LM48548/M12649	\$59.90
007 10521	Bearing Spacer; GM #2 (Metric) Front Spindle; Steel; Adjustable	LM67048/M12649	\$59.90
007 10522	Bearing Spacer; Nascar Mexico/ Canadian Tire Series Front; Aluminum; Adjustable	2796/15120	\$59.90
007 10524	Bearing Spacer; CUP Style Speedway 5x5 Front Hubs; Steel Adjustable	HM803149/2691	\$69.90
007 10525	Bearing Spacer; CUP Style Speedway 5x5 Rear Hubs; Steel; Adjustable	28995/387S	\$69.90
007 10529	Bearing Spacer; Legends; Front; Steel Adjustable	LM67048/LM11949	\$59.90
007 10530	Bearing Spacer; Sprint Car Front; Aluminum; Adjustable		\$46.95
007 10531	Bearing Spacer; Mustang II/Pinto Front Spindle; Steel; Adjustable	L68149/LM12749	\$54.95
007 10532	Bearing Spacer; Camaro Front Spindle; Steel; Adjustable		\$59.90
007 10533	Bearing Spacer; Corvette Front Spindle; Steel; Adjustable		\$59.90
	Other Spacers Available, Call for Applications		
007 10502	Replacement Set Screws For Bearing Spacers; 4 Pack		\$1.25

Precision Bearing Packer

- Inject the Proper Amount of Grease with Precision into Your Hub Bearings
- Saves Time: Pack Entire Set of 8 Hub Bearings in under 10 Minutes
- No Mess! • No Wasted Grease! • Hubs Roll More Freely
- Bearings Run Cooler! • Pack Bearings Less Often!
- Made in the U.S.A.



Packing hub bearings has traditionally been a very messy, time consuming job. Not any longer. The new Precision Bearing Packer from DRP Performance Products takes a routine messy job and makes it enjoyable! Not only is the tool easy to use and fast, it injects the bearing with a .030" stream of grease which allows the user to fill the bearing, in between each roller, with the amount of grease they choose.

Hub bearings are commonly overpacked with grease causing the bearing to run hotter and the hub to pressurize which can cause the hub seal to push out and the bearing grease to overheat. Overpacked bearings typically sling the excess grease into the hub and require packing more often than correctly packed bearings.

Once you try this tool, you will be hooked...and look forward to packing your wheel bearings! Satisfaction Guaranteed! Available for most styles of tapered hub bearings.

Item Number	Bearing Packers	Bearing Seats Included	Price
80520	Precision Bearing Packer Assembly; Wide Five 18690 & 18790 Bearing Seats	80560,80561	\$219.00
80522	Precision Bearing Packer Assembly; 2" 5x5 368A Bearing Seat	80561	\$199.95
80524	Precision Bearing Packer Assembly; Your Choice of Any 2 Bearing Seats	Your Choice of (2)	\$219.00
80526	Precision Bearing Packer Assembly; CUP Style Front & Rear Bearing Seats	80572, 80573, 80574, 80575	\$269.99
80532	Precision Bearing Packer Assembly; 2 7/8" Big Bearing Wide Five (Bert, Winters)	80562	\$199.95
80534	Precision Bearing Packer Assembly; NASCAR® CTS Front & Rear Bearing Seats	80580, 80581, 80570	\$243.99
80536	Precision Bearing Packer Assembly; IMCA Style Front & Rear Bearing Seats	80583, 80584, 80570	\$243.99
80540	Precision Bearing Packer Base Assembly; No Grease Gun or Bearing Seats		\$149.95
80541	Replacement Needle for Bearing Packer		\$12.95
80546	Precision Bearing Packer Base Assembly With Gun Only (No Bearing Seats)		\$164.95

Item Number	Individual Bearing Seats	Fits Bearing Number	Price
80560	BEARING PACKER SEAT ONLY; WIDE FIVE 18690; MOD-LITE 18690	18690	\$19.99
80561	BEARING PACKER SEAT ONLY; WIDE FIVE 18790; 2" 5x5 368A	18790, 368A	\$19.99
80562	BEARING PACKER SEAT ONLY; BERT STYLE WIDE FIVE	8658, OD-BCD-021	\$24.99
80568	BEARING PACKER SEAT ONLY; SHORT TRACK (SCP) 5X5 STYLE; FRONT OUTER; 2687	2687	\$19.99
80569	BEARING PACKER SEAT ONLY; SHORT TRACK (SCP) 5X5 STYLE; FRONT INNER; 3383	3383	\$19.99
80570	BEARING PACKER SEAT ONLY; SHORT TRACK (SCP) 5X5 STYLE; REAR L610549	L610549	\$24.99
80572	BEARING PACKER SEAT ONLY; CUP STYLE REAR INNER; 28995	28995	\$24.99
80573	BEARING PACKER SEAT ONLY; CUP STYLE REAR OUTER; 387S	387S	\$24.99
80574	BEARING PACKER SEAT ONLY; CUP STYLE FRONT INNER; HM803149	HM803149	\$19.99
80575	BEARING PACKER SEAT ONLY; CUP STYLE FRONT OUTER; 2691	2691	\$19.99
80580	BEARING PACKER SEAT ONLY; NASCAR CANADIAN/MEXICO FRONT INNER; 2796	2796	\$19.99
80581	BEARING PACKER SEAT ONLY; NASCAR CANADIAN/MEXICO FRONT OUTER; 15120	15120	\$19.99
80583	BEARING PACKER SEAT ONLY; PINTO/MUSTANG II INNER; L68149	L68149	\$19.99
80584	BEARING PACKER SEAT ONLY; PINTO/MUSTANG II OUTER; LM12749	LM12749	\$19.99
80585	BEARING PACKER SEAT ONLY; IMPALA INNER; (SET 5)	LM48548	\$19.99
80586	BEARING PACKER SEAT ONLY; IMPALA OUTER; GM MID SIZE (METRIC) OUTER, (SET 3)	M12649	\$19.99
80587	BEARING PACKER SEAT ONLY; GM MID SIZE (METRIC) INNER ; LEGENDS INNER; (SET 6)	LM67048	\$19.99
80590	BEARING PACKER SEAT ONLY; LEGENDS OUTER; USE 80587 INNER; LM11949	LM11949	\$19.99

Hub End Play Gauge

How have we made it this long without this tool? We originally designed our new hub end play gauge for our internal use. Then we used it and realized, everyone should have one of these tools in their box! Measure hub end play to .0005" accurately right on the car. This is the best way to check bearing spacer set-up we've found, period. Simple and quick to use.

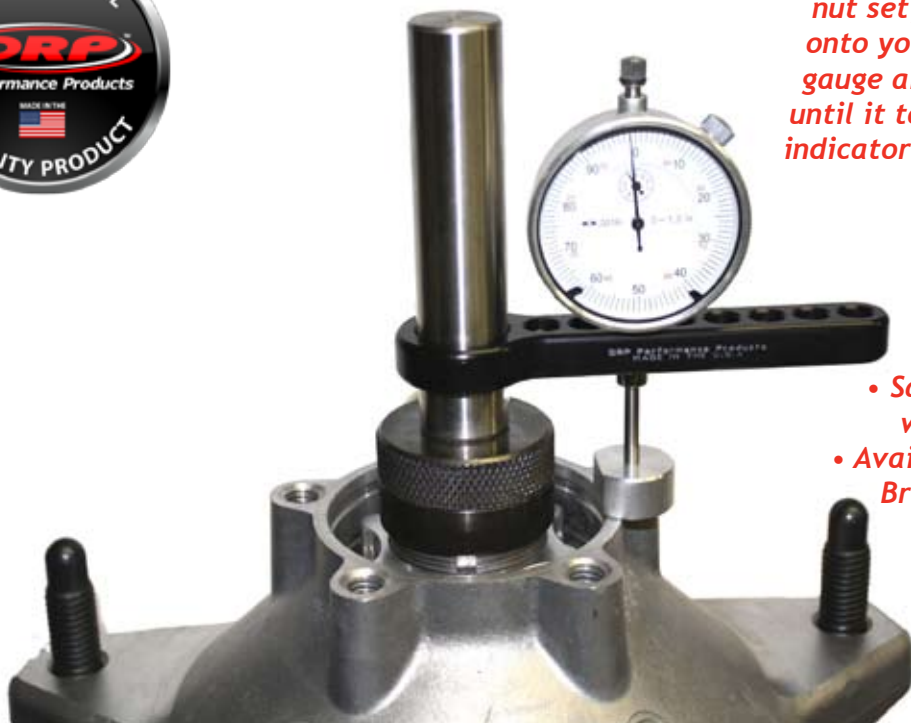

To Use:

With the hub installed and spindle nut set, simply thread the gauge shaft onto your spindle snout. Next slide the gauge arm with indicator onto the shaft until it touches the edge of the hub. Zero indicator and pull hub. Indicator will read total end play.

- Measure Hub End Play to .0005" on the car!
- Increase Hub "Free Spin"
- Saves Time & Increases Accuracy when Setting Bearing Spacers
- Available for All Popular Hub Styles & Brands (Custom Tools Available)
- Satisfaction Guaranteed!

Item Number	Description	Price
007 80850	Hub End Play Gauge; Wide Five/2" 5x5	\$159.00
007 80852	Hub End Play Gauge; 2 7/8" Wide Five (Big Bearing/Bert/Winter's Style)	\$189.00
007 80855	Hub End Play Gauge; GN (Short track) 5x5 Front (SCP Style)	\$129.90
007 80857	Hub End Play Gauge; 2.5" GN (Short Track) 5x5 Rear (SCP/L610549 Style)	\$159.00
007 80860	Hub End Play Gauge; Speedway 5x5 Front (CUP Style)	\$129.90
007 80862	Hub End Play Gauge; Speedway 5x5 Rear (CUP Style)	\$159.00
007 80865	Hub End Play Gauge; Mustang/Pinto Front (IMCA)	\$129.90
007 80867	Hub End Play Gauge; GM Front	\$129.90
Replacement Components & Adapters		
007 80880	Hub End Play Arm Only	\$61.50
007 80882	Hub End Play Dial Indicator with Pad Only	\$39.95
007 80885	Hub End Play Spindle Mandrel Only; Wide Five/2" 5x5	\$71.50
007 80886	Hub End Play Spindle Mandrel Only; GN (Short track) 5x5 Front (SCP Style)	\$39.90
007 80887	Hub End Play Spindle Mandrel Only; GN (Short Track) 5x5 Rear (SCP Style)	\$71.50

Ultra Low Drag Hub Seals

You will be pleased with our new Ultra Low Drag hub seals. These new seals feature a lightweight aluminum housing and Teflon sealing ring. DRP ultra low drag seals have the lowest resistance of any conventional seal we've tested and are the lightest weight seal available. Large spindle contact area makes this seal excellent at keeping debris out of your bearings. Works on steel and aluminum tubes, asphalt or dirt applications. Made in the USA! Ultra Durable, Ultra Light, Ultra Low Drag!

- **Lightweight Aluminum Housing**
- **One Piece Teflon Sealing Ring**
 - **Extremely Durable**
 - **Ultra Low Drag**
- **Hubs Spin More Freely**
- **Less Rotating Weight**
 - **Reusable**



Item Number	Description	Price
007 10559	Ultra Low Drag Hub Seal; Aluminum, Housing; Wide Five	\$29.90
007 10564	Ultra Low Drag Hub Seal; Aluminum Housing; Wide Five	\$29.90

Standard & Low Drag Hub Seals

Item Number	Description	Price
007 10560	Seal; Low Drag; Wide Five; Coated Contact Type (Green)	\$19.90
007 10561	Seal; Low Drag; 2" 5x5; Coated Contact Type (Green)	\$19.90
007 10562	Seal; Low Drag; Wide Five; Non Contact Type (Orange)	\$28.90
007 10563	Seal; Low Drag; 2" 5x5; Non Contact Type (368A) (Orange)	\$28.90
007 10567	Seal; Low Drag; 2.5" 5x5 Short Track Rear; Non-Contact (L610549) (Orange)	\$24.90
008 57023756	Seal; Standard Wide Five (Blue)	\$3.95



Seal Specifications & Test Results			
Seal Type	Part Number	Weight (4 pcs)	Drag (4 pcs) in lbs
DRP Ultra Low Drag (Wide Five)	007 10559	4.7 oz	5 in lbs
Standard Wide Five (Blue)	008 57023756	10.2 oz	20+ in lbs
Low Drag Wide Five (Green)	007 10560	7.1 oz	7 in lbs
Timken Style Non Contact W/F (Orange)	007 10562	15 oz	7 in lbs
DRP Ultra Low Drag (2" 5x5)	007 10564	4.7 oz	5 in lbs
Standard 5x5 (Blue)	n/a	10.2 oz	20+ in lbs
Low Drag 5x5 (Green)	007 10561	11.8 oz	7 in lbs
Timken Style Non Contact 5x5 (Orange)	007 10563	15 oz	7 in lbs

Seal Drivers

Use our hub seal drivers to make installing seals easy. Drivers quickly pay for themselves by avoiding damage and wasting seals. Premium quality, lifetime tool.

Item Number	Description	Price
007 80500	Seal Driver; Wide Five & 2" 5x5 Hubs	\$48.00
007 80502	Seal Driver; CUP Style (Speedway) Front Hubs	\$48.00
007 80503	Seal Driver; Cup Style (Speedway) Rear Hubs	\$48.00
007 80504	Seal Driver; Nascar Canadian & Mexico Front Hubs	\$48.00
007 80505	Seal Driver; 5x5 Front Hubs (SCP Style)	\$48.00
007 80506	Seal Driver; 2.5" 5x5 Rear Hubs (L610549)	\$48.00
007 80508	Seal Driver; Front Bert Style Wide Five Hubs	\$56.00
007 80509	Seal Driver; Rear Bert Style Wide Five Hubs	\$56.00
007 80510	Seal Driver; Mustang Front (Popular Modified)	\$48.00
007 80511	Seal Driver; Speedway Engineering Mod-Lite	\$48.00

- **Saves Time & Money!**



"Let us run with endurance the race that is set before us..." Hebrews 12:1

Low Drag Hub Bearing Kits

After testing all types of low drag bearing and seal combinations, we have settled on these Timken® brand bearings which have been REM® process finished for an ultra smooth surface and minimum resistance. We offer both low drag contact seals and no drag non contact seals. Wide five bearing kits include standard 18690 and 18790 bearing sizes to fit all popular wide five hubs. 2" 5x5 bearing kits include standard 368A bearing sizes to fit all popular 2" 5x5 hubs including PCR, ARCO, HOWE, JOES, SIERRA and SPEEDWAY ENGINEERING.

Item Number	Description	Price
007 10550	Bearing Kit; Wide Five; Timken® REM® Finished; 1 Wheel Set	\$79.96
007 10553	Race Kit; Wide Five; Timken® REM® Finished; 1 Wheel Set	\$29.90
007 10555	Bearing Kit; 2" 5x5; Timken® REM® Finished; 1 Wheel Set	\$87.90
007 10557	Race Kit; 2" 5x5; Timken® REM® Finished; 1 Wheel Set	\$66.50
007 10580	Impala Front Bearing Kit; Timken® REM® Finished; 1 Wheel Set	\$59.38
007 10581	GM Metric Front Bearing Kit; Timken® REM® Finished; 1 Wheel Set	\$68.50
007 10581R	GM Metric Front Race Kit; Timken® REM® Finished; 1 Wheel Set	\$48.50
007 10582	Bearing Kit; 2.5" GN 5x5 Rear; (L610549); Timken® REM® Finished; 1 Wheel Set	\$199.00
007 10583	Race Kit; 2.5" GN 5x5 Rear; (L610510); Timken® REM® Finished; 1 Wheel Set	\$92.00
007 10584	Bearing Kit; Mustang Front (L68149/LM12749); Timken® REM® Finished; 1 Wheel Set	\$52.50
007 10585	Bearing Kit; Legends Front; (LM67048/LM11949) Timken® REM® Finished; 1 Wheel Set	\$52.50
007 10587	Bearing Kit; Nascar Canada/Mexico Front; (15120/2796) Timken® REM® Finished; 1 Wheel Set	\$88.20
007 10590	Bearing Kit; Speedway Eng. Mod-Lite; (18690) Timken® REM® Finished; 1 Wheel Set	\$79.96
007 PWB	Injection Pack Wheel Bearing; 30-50% Full; Timken® Grease (New or Clean Bearing) Price is per bearing.	\$5.00
007 RF85	RF-85 Treatment for Wheel Bearing (Per Bearing)	\$50.00



New! Low Drag Hub Parts Kits

Order all the components we use in our Race Ready Low Drag Hub Assemblies in one kit. Set-up instructions included. Use with our hub end play gauges for precise set-up.



Item Number	Description	Price
007 10500K	Wide Five Low Drag Hub Parts Kit; Includes: 10500 Spacer; REM® Timken® Bearing Kit; DRP Ultra Low Drag Seal	\$139.90
007 10505K	2" 5x5 Low Drag Hub Parts Kit; Spacer; (2) 368A REM® Finished Timken® Bearings; DRP Ultra Low Drag Seal	\$149.90
007 10518K	2.5" 5x5 Rear Low Drag Hub Parts Kit; Includes: 10518 Spacer, (2) L610549 REM® Finished Timken® Bearings, Non-Contact Low Drag Seal	\$269.90

Hub Measurement & Building Service

Send us your clean hubs and we can build you a set of low drag hubs precisely set for maximum performance. We can use your quality bearings (we inspect each bearing) or use our low drag bearing kits. Hubs are measured, spacers set, bearings packed and seal installed. Hubs are returned to you "race ready".



Item Number	Description	Price
007	Low Drag Hub Set-Up Labor Only (Parts sold separately)	\$30.00



Performance Products

DRP Performance Products
2089 Crooked Oak Rd.
Rocky Mount, VA 24151
888-399-6074